

CAPILLARY BLOOD COLLECTION KIT (SST & EDTA)

A capillary blood sample collection kit used for the collection and transportation of samples for laboratory analysis of serum, whole blood and plasma based parameters

This kit contains the materials required for either sample self-collection or collection by a health/social care professional.

IVD For *in vitro* diagnostic use, sample self-collection

REF KT355



i Carefully read the enclosed instruction leaflet before use

! Important: Do not use kit if security seal is broken. Keep out of reach of children

⌘ Do not re-use

18+ For use by persons aged 18 and over

Sample collection instructions (Steps 1–17)

- Please ensure the kit is within expiry date and read these instructions carefully and completely before attempting to collect the sample.
- If your kit requires online activation, please follow the instructions provided by your healthcare organisation. If you need assistance please contact the healthcare organisation who arranged the test.

Your sample collection kit contents

Please check that the kit contains all of the items outlined below. Do not proceed with sample taking if any items are missing or damaged, contact the healthcare organisation who arranged your test for assistance.

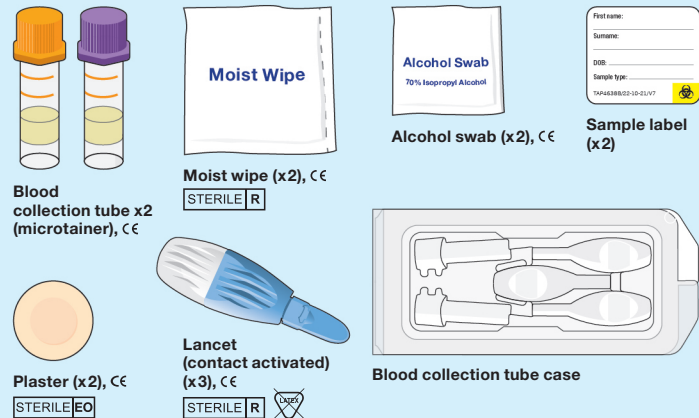

IMPORTANT!

The BLUE lancet activates on contact when positioned and pressed against the skin. Lancets are for single use only.

IMPORTANT!

The blood collection tube case has been designed to provide a stable way of holding the blood collection tubes whilst a sample is taken. Please insert the tubes as shown above, remove each cap and put it by the side of the tube whilst you take your sample. Do not mix up tube caps, only replace them back on to the tube(s) they came from.

Security Seal

To Open Box - Tear Seal & Lift Flap
MDX001.com

Return security label



Return postal envelope



Collection kit outer box

BLOOD SAMPLE COLLECTION

1 If not already pre-populated please complete the test request form, provided by your doctor/clinic, separate to this kit. **Make sure the sample date is completed.**



2 Clearly complete the blood collection tube label using a ball point pen with:

- Your First name
- Your Surname
- Your Date of birth
- Sample type: Blood

Do not affix it to the tube at this stage.



3 IMPORTANT SAMPLE TRACKING INFORMATION!

The enclosed postal envelope has a postal tracking label applied. Please make a note of the unique tracking number displayed under the barcode on the postal tracking label, as shown below. Keep this in a safe place for future reference. **You can track delivery of your Royal Mail parcel by entering this number using the following link:** <http://www.royalmail.com/track-your-item>



Write your tracking number here for reference – keep this safe.

4 Take each blood collection tube out of the case and insert the tubes as shown. **Remove each tube cap and put it to the side of the corresponding tube** whilst you take your sample.

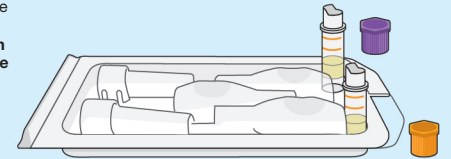

5 The best location for collecting a finger prick sample is from the side of your middle or ring finger (see shaded area). Open the pack of lancets.

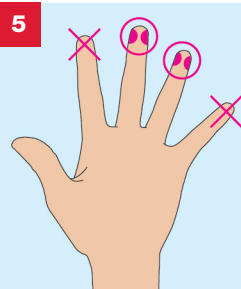

6 Wash your hands in warm soapy water. **It is much easier to collect your sample if your hands are warm.** Dry them thoroughly with a clean, dry towel.



7 Using the Alcohol Swab wipe the selected finger. **Be sure your finger is completely dry as blood will not form a drop at the puncture site of a moist finger.**



8 Remove one lancet from the bag. Twist and remove the blue stick. The lancet is ready to use.

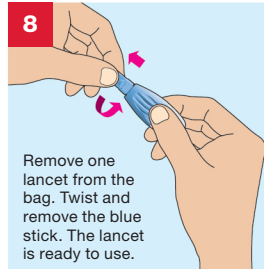

9 Position the lancet against the side of your chosen finger. The lancet will activate in one step only when positioned and pressed **FIRMLY** against the skin until a click is heard. Should you need to repeat the process to help obtain enough blood use one of the remaining lancets.

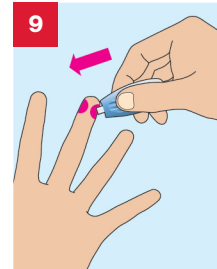

10 This will puncture the skin and a small drop of blood will form. Wipe away the first drop of blood with a tissue.

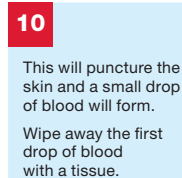

11 Holding your hand/arm downwards, firmly massage your hand down to your finger, without squeezing, to encourage blood flow.

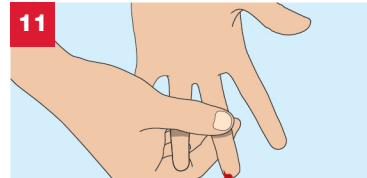

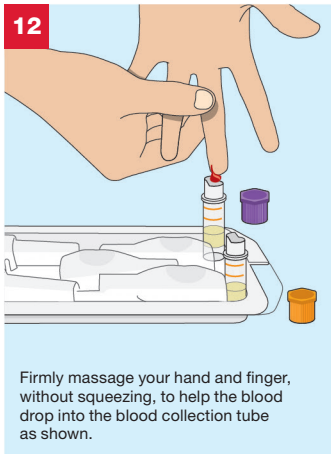

Firmly massage your hand and finger, without squeezing, to help the blood drop into the blood collection tube as shown.

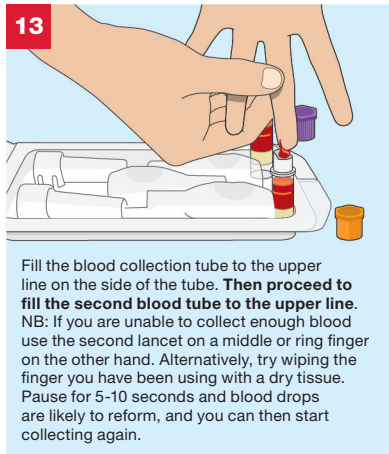

Fill the blood collection tube to the upper line on the side of the tube. **Then proceed to fill the second blood tube to the upper line.**
 NB: If you are unable to collect enough blood use the second lancet on a middle or ring finger on the other hand. Alternatively, try wiping the finger you have been using with a dry tissue. Pause for 5-10 seconds and blood drops are likely to reform, and you can then start collecting again.

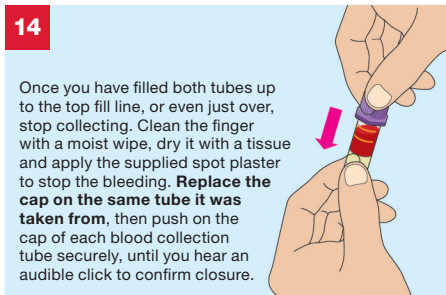

Once you have filled both tubes up to the top fill line, or even just over, stop collecting. Clean the finger with a moist wipe, dry it with a tissue and apply the supplied spot plaster to stop the bleeding. **Replace the cap on the same tube it was taken from**, then push on the cap of each blood collection tube securely, until you hear an audible click to confirm closure.

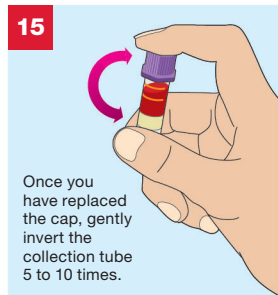

Once you have replaced the cap, gently invert the collection tube 5 to 10 times.

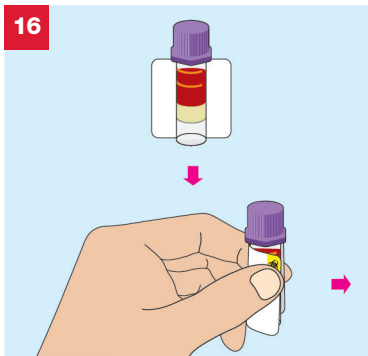

Make sure each tube is labelled with your details using the blood collection tube label supplied. **This is very important as unlabelled samples cannot be accepted.**
 Affix the label by placing the tube in the middle of the label and wrapping the label around the tube, as shown below.
Place the collection tube back into the clear case provided.

Warnings and precautions

- This kit is designed for use by persons aged 18 and over and upon request of a healthcare professional or healthcare organisation.
- Please consult with a healthcare professional for guidance on sample collection processes for adolescent and younger children.
- The kit should not be used by individuals lacking the physical or mental capacity to correctly follow the self-collection instructions. If you have problems or feel unwell or lightheaded during the collection process, please pause and if necessary, consult with your advising healthcare professional.
- For persons with bleeding or clotting disorders, those taking anti-coagulants, immunosuppressive drugs or undergoing chemotherapy this kit should be used with caution and under the clinical guidance of a healthcare professional.
- Do not affix the label to the blood collection tube until after you have collected your sample. You will not be able to see how much blood you have collected if the label covers the tube.
- The accuracy of your results may be compromised if you do not read and follow the instructions in full.
- Samples arriving at the laboratory which show signs of haemolysis, degradation or general damage or arrive after 6 days of sample taking may not be tested.
- Please note that some medicines or medicinal products may be considered interfering substances for certain biochemical or immunoassay investigations. Please consider the potential impact of interfering substances when interpreting results.
- Where appropriate, out of range, abnormal or positive test results deemed clinically significant should be confirmed with a confirmatory venous sample.

Materials required but not provided

- **Test request form.** This will be provided by your healthcare professional or healthcare organisation. **Please complete the request form with your details as instructed.**
- **Clean tissue paper**

Laboratory Tests

- The tests and procedures undertaken by The Doctors Laboratory Limited are verified and performed in line with supplier product instructions for use and supported by additional validation data for use with self-collection procedures.
- Test results are provided in line with clinically approved results pathways, agreed between The Doctors Laboratory Limited and the patients designated healthcare professional or healthcare organisation.

17 IMPORTANT CHECKLIST

Before you return your sample please do the following:

- Place your completed request form supplied by your doctor/clinic into the postal envelope
- Make sure each blood collection tube is labelled
- Place all blood collection tubes and any used and/or spare lancets back into the protective case and firmly close
- Place the protective case into the collection kit outer box
- Close the collection kit outer box firmly and apply the return security label to seal it
- Place the collection kit outer box into the return postal envelope
- Check that you have taken note of your postal tracking number

You are now ready to seal the postal envelope. Please store at room temperature until posted.

Please post your sample to **The Doctors Laboratory** as soon as possible (ideally on same day or within 24 hours of sample collection) from **ANY** Royal Mail post box in the UK. No stamp is required within the UK.

If you need assistance please contact The Doctors Laboratory on **020 7307 7373** or email **samples@tdlpathology.com**.



We would welcome feedback on your experience of using this self-collection kit to help us improve our services. To complete a short online survey please scan the code or visit:

<https://forms.office.com/r/0xDA0byp1W>

KEY TO SYMBOLS

IVD	For <i>in vitro</i> diagnostic use	Use by end of year-month	UK CA	UK Conformity Assessed
REF	Catalogue number	Manufacturer	CE	EU Conformity Assessed
LOT	Batch code	EC REP		EU Authorised Representative
STERILE R	Sterilized using irradiation	Temperature limits: 4°-25°C	No re-use	Do not re-use
STERILE EO	Sterilized using ethylene oxide	Caution, consult accompanying documents	No latex	Not made with natural rubber latex
Biohazard	Biological risk. Biological sample, treat as potentially infectious	Keep away from sunlight	Instructions	Consult instructions for use
Damaged package	Do not use if package is damaged	Distributor	18+	For use by persons aged 18 and over
			Umbrella	Keep dry

REAL Digital International Limited, 2 Queensway, Croydon, Surrey, CR0 4BD, UK
 Website: www.real-digital.co.uk

Casus Europe BV, Lange Viestraat 2 B, 3511BK Utrecht, The Netherlands.

The Doctors Laboratory Limited
 Distribution is restricted to regions in which the product is registered by the manufacturer.

© The Doctors Laboratory Limited, 2024. Illustrations: © Jag Matharu/Thin Air Productions
 RDI-IFU-007, TAP4872C/05-02-24/V21. Issue No. 2; Date 05/02/24.

Revision/Date Change summary

Revision/Date	Change summary
1 02/2023	Initial RDI product for UK market
2 02/2024	RDI IVD product CE registration

If any serious incident occurs in relation to the use of this kit, it should be reported to the manufacturer and the competent authority of the Member State in which the user and/or the patient is established.